

TANKS & MIXING TANKS Ø 520 - 2550

ATMOSPHERIC TANKS

Atmospheric vessel.
 Material: Hand lay-up polyester with fiberglass (max quality polyester tech).
 Steel reinforced GRP vessel.
 All connections are part of the structure of the filter in GRP.
 Design temperature 40°C.
 R model Flat bottom
 RP Closed legs.

ADDITIONAL OPTIONS

Higher temperatures.
 High-chemical resistance.
 Additional sight glass.
 Additional flanges.
 Anchorage system to ground.
 Seismic calculations.



WHY CALPLAS MIXING TANKS?

CALPLAS mixing tanks can be either with legs (for complete emptying) or without legs. Stirrer support are also available. Flanges can be inserted wherever they are required. Other options such as level indicator, deflectors are also available. The tanks are be manufactured according to the required chemical resistance on each case.

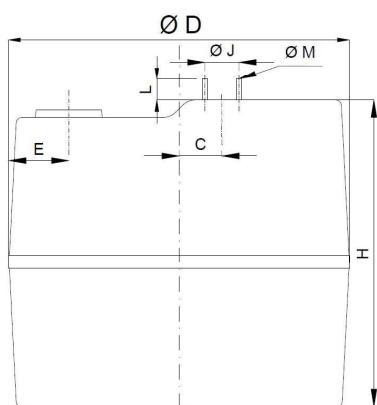

RP TANKS

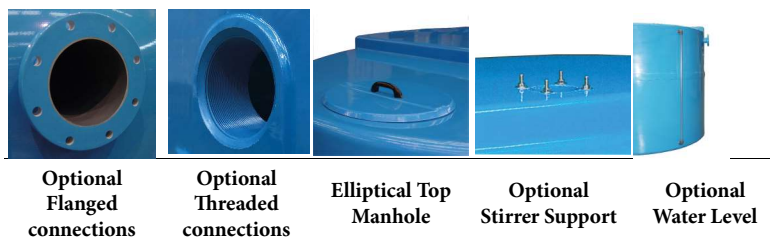
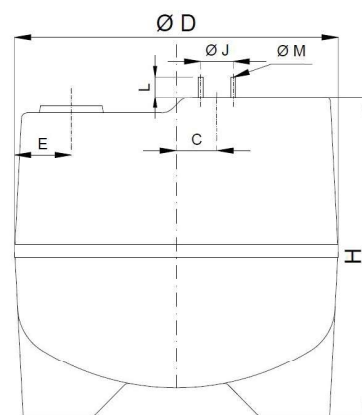

Optional Flanged connections

Optional Threaded connections

Elliptical Top Manhole

Optional Stirrer Support

Optional Water Level

Ø	520	640	720	840	1010	1260	1440	1640	2040	2040	2040	2340	2550
ID	R - 02	R - 03	R - 04	R - 06	R - 10	R - 13	R - 17	R - 25	R - 35	R - 45	R - 50	R - 75	R - 100
H	1050	1050	1050	1330	1330	1330	1330	1330	1330	1605	1880	1880	2110
Volume	200	300	400	660	975	1500	2000	2575	4000	4880	5750	7600	10000
ID	RP - 02	RP - 03	RP - 04	RP - 06	RP - 10	RP - 13	RP - 17	RP - 25	RP - 35		RP - 50	RP - 75	RP - 100
H	1015	1035	1065	1075	1360	1460	1500	1610	1670		1970	2035	2110
Volume	140	240	340	520	840	1350	1870	2550	4000		5000	7000	9000

OPTIONS

GRP Deflector (3 inside)

Mixing funnel

Stirrer support / Tank in the top

Water level indicator

High Chemical resistance for tanks