

# STANDARD AFM® / SAND FILTERS

## AFM® SERIES Ø 520-960



Ref	ID	Ø D	H	O	M	A	B	I/O	Filt. Surface	AFM® G3 / G2 / G1 (21 Kg) Sand(2-3/0.7-1.2/0.4-0.8)(25 Kg)
112152.X	AFM-520	520	1400	190	305	405	190	2"	0,20 m <sup>2</sup>	0 / 3 / 8
112164.X	AFM-640	640	1440	190	305	420	190	2"	0,30 m <sup>2</sup>	0 / 5 / 12
112172.X	AFM-720	720	1440	190	305	420	190	2"	0,40 m <sup>2</sup>	0 / 6 / 16
112184.X	AFM-840	840	1460	190	305	440	190	2"	0,52 m <sup>2</sup>	3 / 4 / 24
112196.X	AFM-960	960	1520	205	355	405	250	2 ½"	0,70 m <sup>2</sup>	5 / 5 / 34

### AFM® SERIES 900 - 1000 BED HEIGHT

Design pressure 2,5 Kg/cm<sup>2</sup> | Test pressure 3,75 Kg/cm<sup>2</sup>.  
 Lateral access manhole.  
 Internal steel reinforced filter.  
 Sight glass.  
 Special diffuser for Sand / AFM®.  
 Female threads (GAS) in GRP are part of the body.  
 Large diameter internal piping designed for both Sand / AFM® requirements.  
 Laterals designed for proper filtration and backwash.

### ORIENTATION OPTIONS Dimensions in mm.

Pos 6 **X**=6 (Standard)  
 Pos 2 **X**=2

### SIGHT GLASS ALWAYS INCLUDED

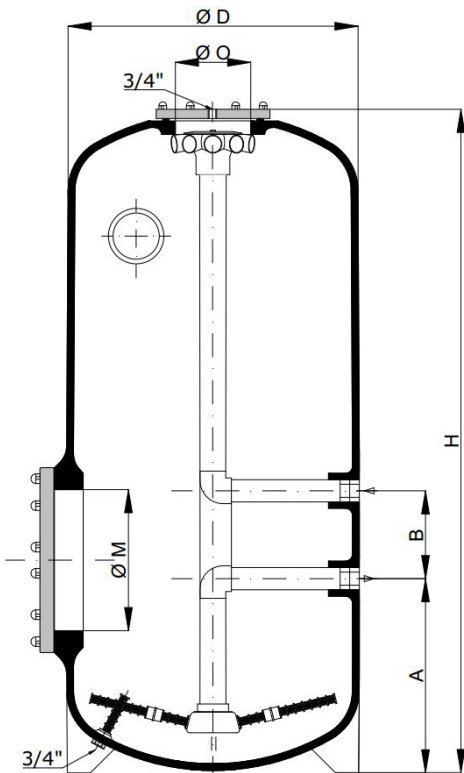

### MANOMETER KIT INCLUDED



Optional  
Manhole  
&  
Sightglass  
Pos 2

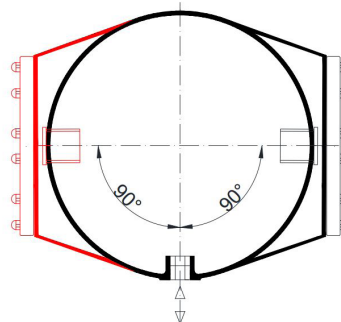

Standard  
Manhole  
&  
Sightglass  
Pos 6



Threaded connections  
integrated in body

Transparent top lid

Access manhole

Top diffuser

Sight glass

Laterals

Drain plug

